

Installation of Self Adhesive Heater Mats

- Care should be taken not to bend, crease or fold the element especially while the backing paper is on the mat.
- Ensure surface to be heated is clean of grease and dirt (use cleaning solvent if required).
- Peel release paper from farthest corner away from the lead connection (as Fig.1)
- Place the heater mat into position immediately after peeling off the paper to avoid any dust or grit adhering to the heater (as Fig. 2)
- Place the heater mat into exact position, roll from one edge against the surface to be heated and press firmly ensuring good even contact (as Fig. 3)
- Route and secure heater mat cold lead/cable
- Visually inspect heater mat installation.
- Electrically static test heater mat for correct element resistance reading and earth isolation.
- Equipment that the heater mat is fitted to should provide protection against electrical shock according to relevant European standards.

Note. Once heater mat is installed it cannot be re-applied

Fixing of Self Adhesive Heater Mats

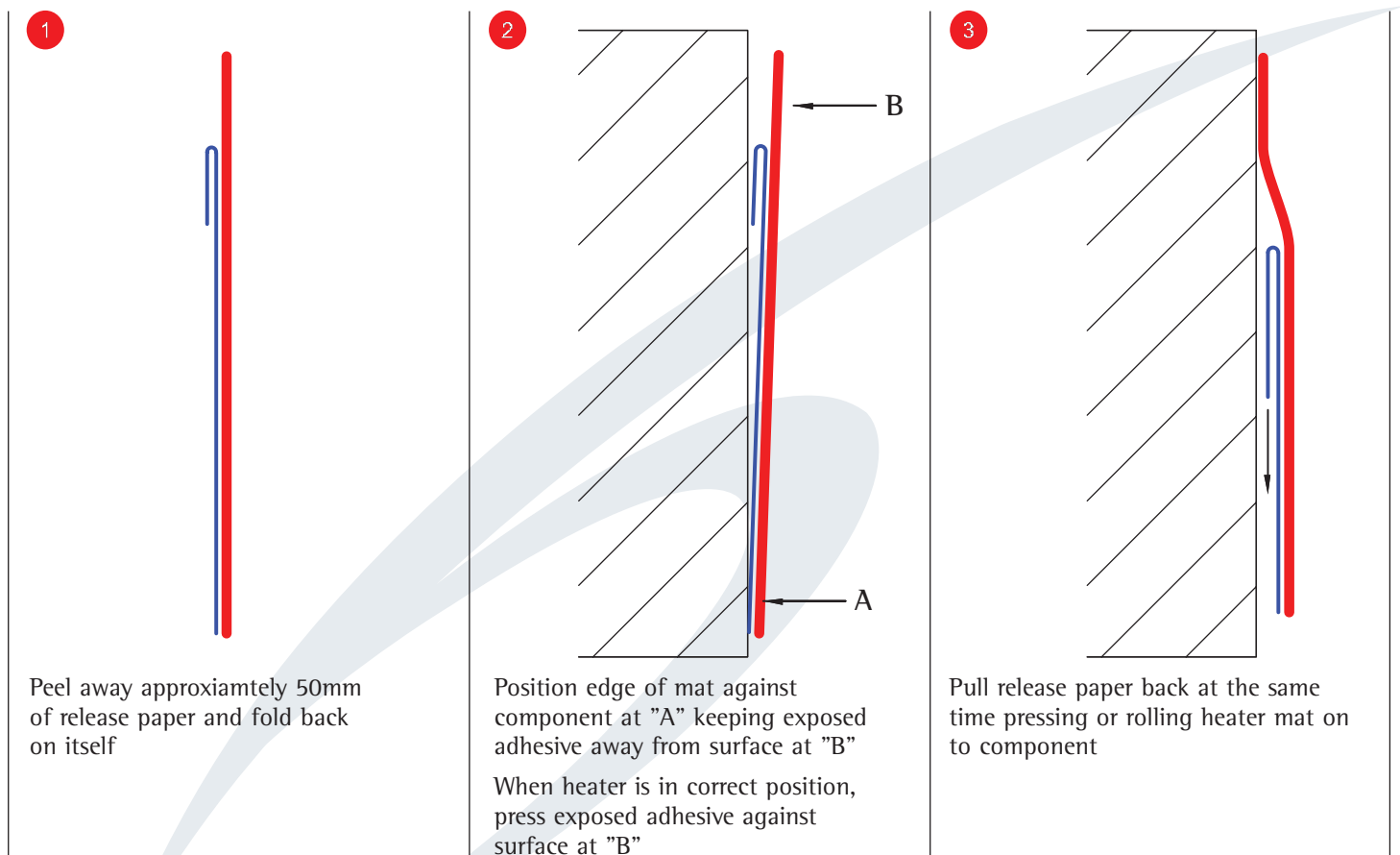

Holroyd Components
ISO9001:2000
File No. A10510



Holroyd Components Ltd.

Shire Hill Industrial Estate, Saffron Walden, Essex CB11 3AQ
United Kingdom

Tel: +44 (0) 1799 523177

Fax: +44 (0) 1799 513714

sales@holroydcomponents.com

www.holroydcomponents.com